

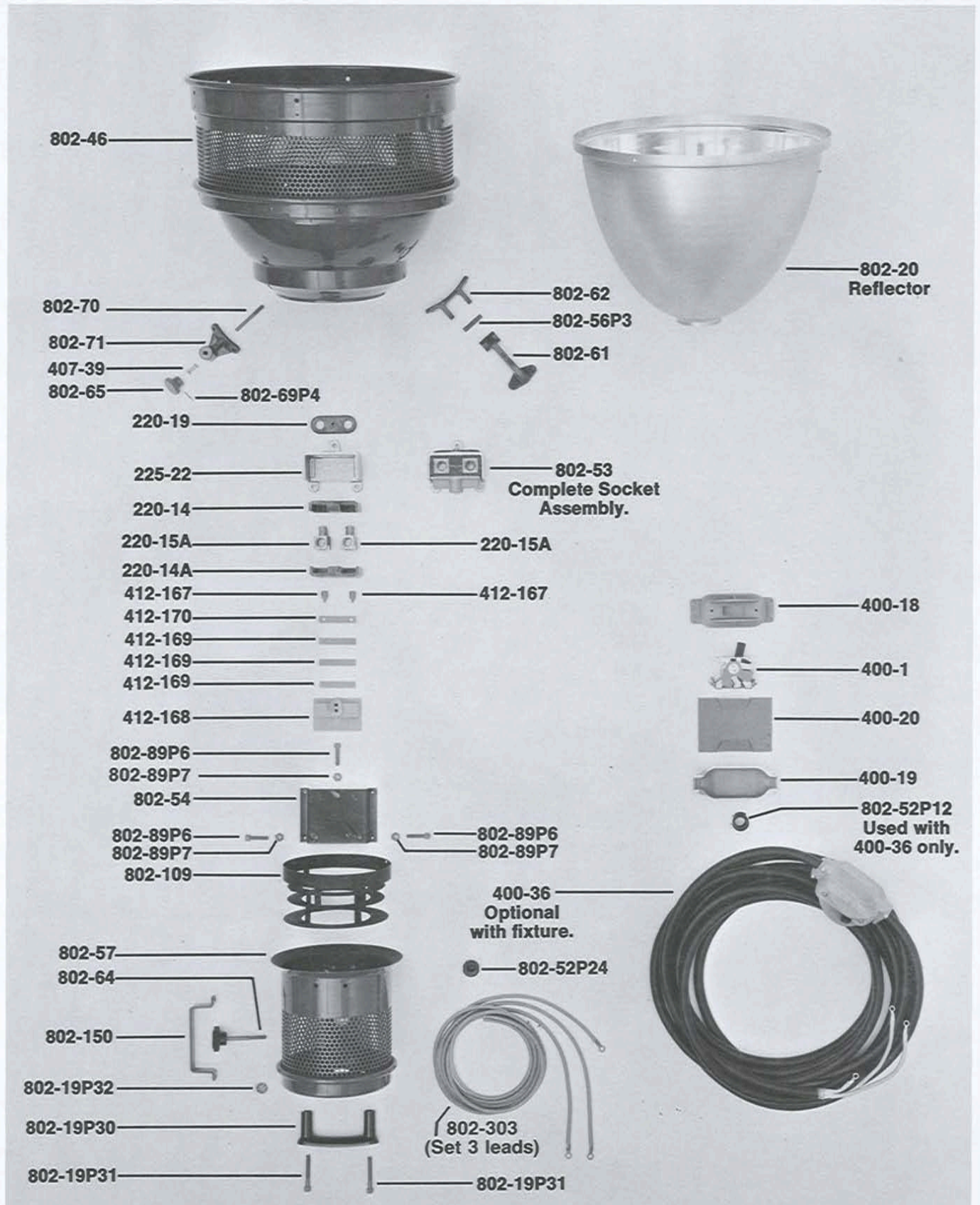

# PARTS FOR TYPE 8021 2,000 WATT MOLEQUARTZ® MOLELIPSO®

8021A941



205



*Mole-Richardson Co.*



Tel. (323) 851-0111 Fax. (323) 851-5593 E-mail: info@mole.com Internet: http://www.mole.com 937 N. Sycamore Ave., Hollywood, California 90038-2384 U.S.A.

©Mole-Richardson Co., Hollywood, California U.S.A.





# PARTS FOR TYPE 8021 2,000 WATT MOLEQUARTZ® MOLELIPSO®

8021B941

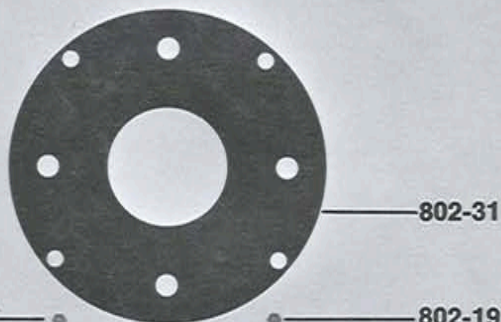

- 802-19P22
- 802-19P20
- 802-19P21
- 802-19P21
- 802-19P19
- 802-19P20
- 802-36
- 802-38
- 802-39
- 802-37
- 802-35
- 802-19P21
- 802-19P20
- 802-19P19

- 802-19P22
- 802-19P20
- 802-19P21
- 802-19P21
- 802-19P19
- 802-19P20
- 802-36
- 802-38
- 802-39
- 802-37
- 802-35
- 802-19P21
- 802-19P20
- 802-19P19

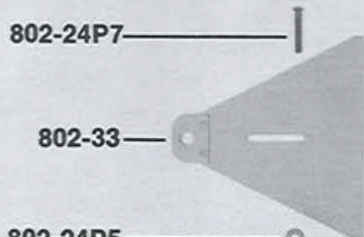

- 802-24P5
- 555-87
- 802-24P6

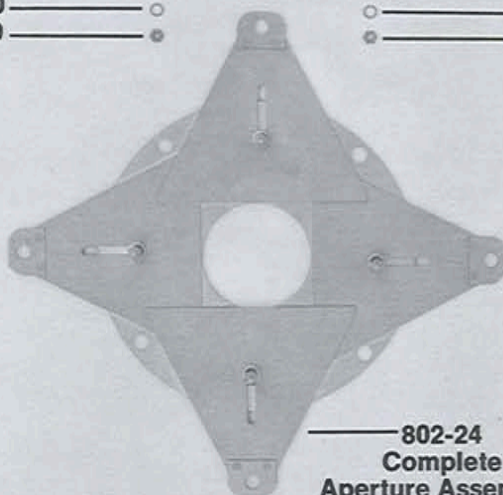

802-24  
Complete  
Aperture Assembly.

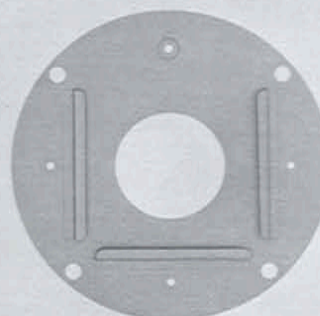

802-21  
Aperture Plate.

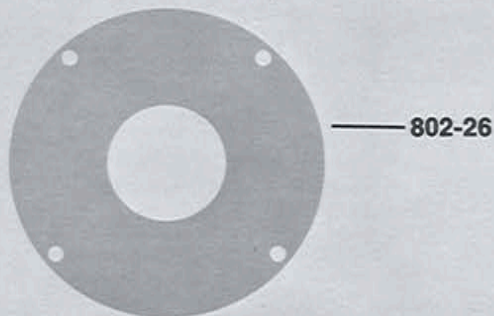

802-26

206



*Mole-Richardson Co.*





# PARTS FOR TYPE 8021 2,000 WATT MOLEQUARTZ® MOLELIPSO®

8021C941

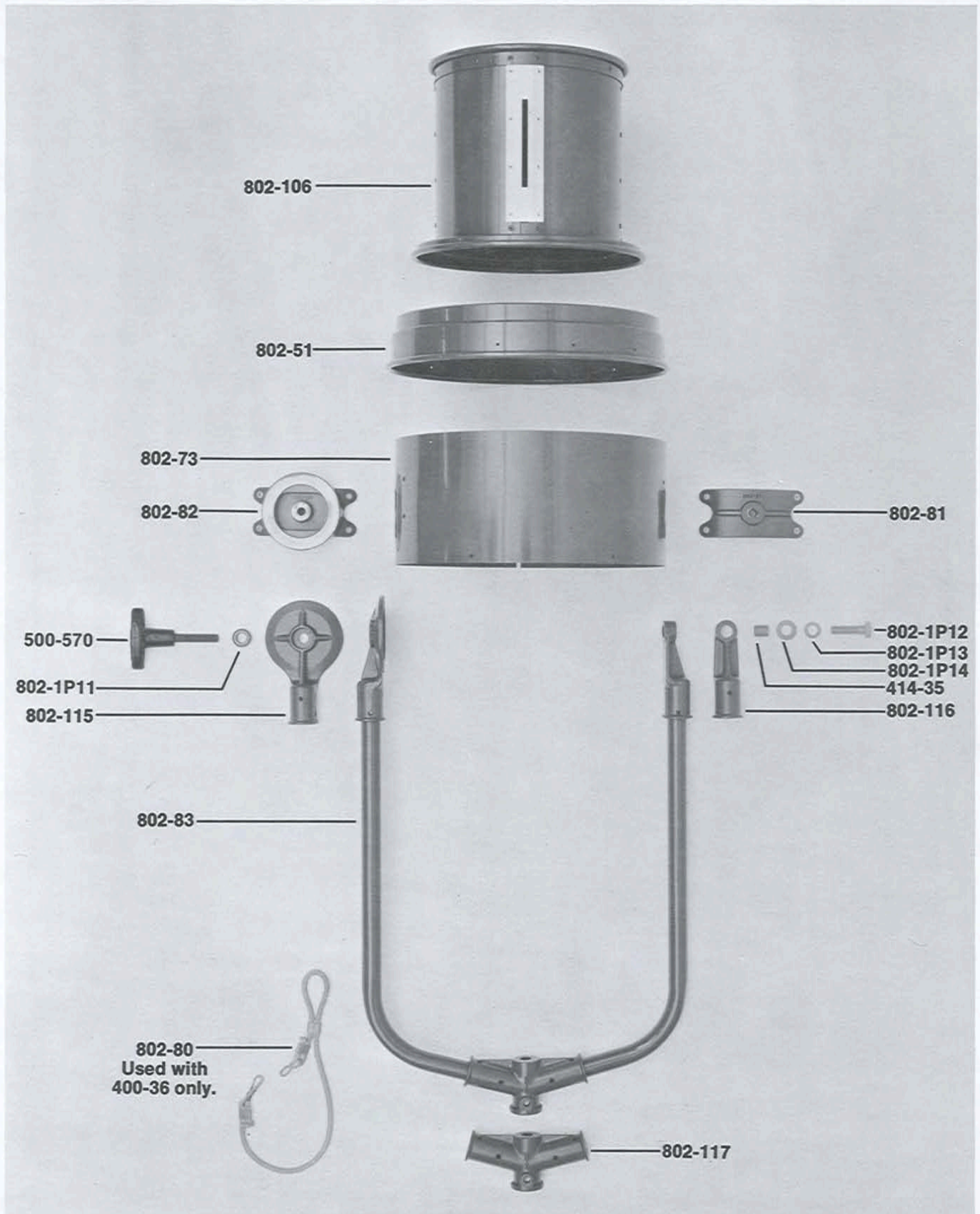

207



*Mole-Richardson Co.*



Tel. (323) 851-0111 Fax. (323) 851-5593 E-mail: info@mole.com Internet: http://www.mole.com 937 N. Sycamore Ave., Hollywood, California 90038-2384 U.S.A.

©Mole-Richardson Co., Hollywood, California U.S.A.





# PARTS FOR TYPE 8026 AND 8028 ACCESSORY LENS ASSEMBLIES

8021D941

208

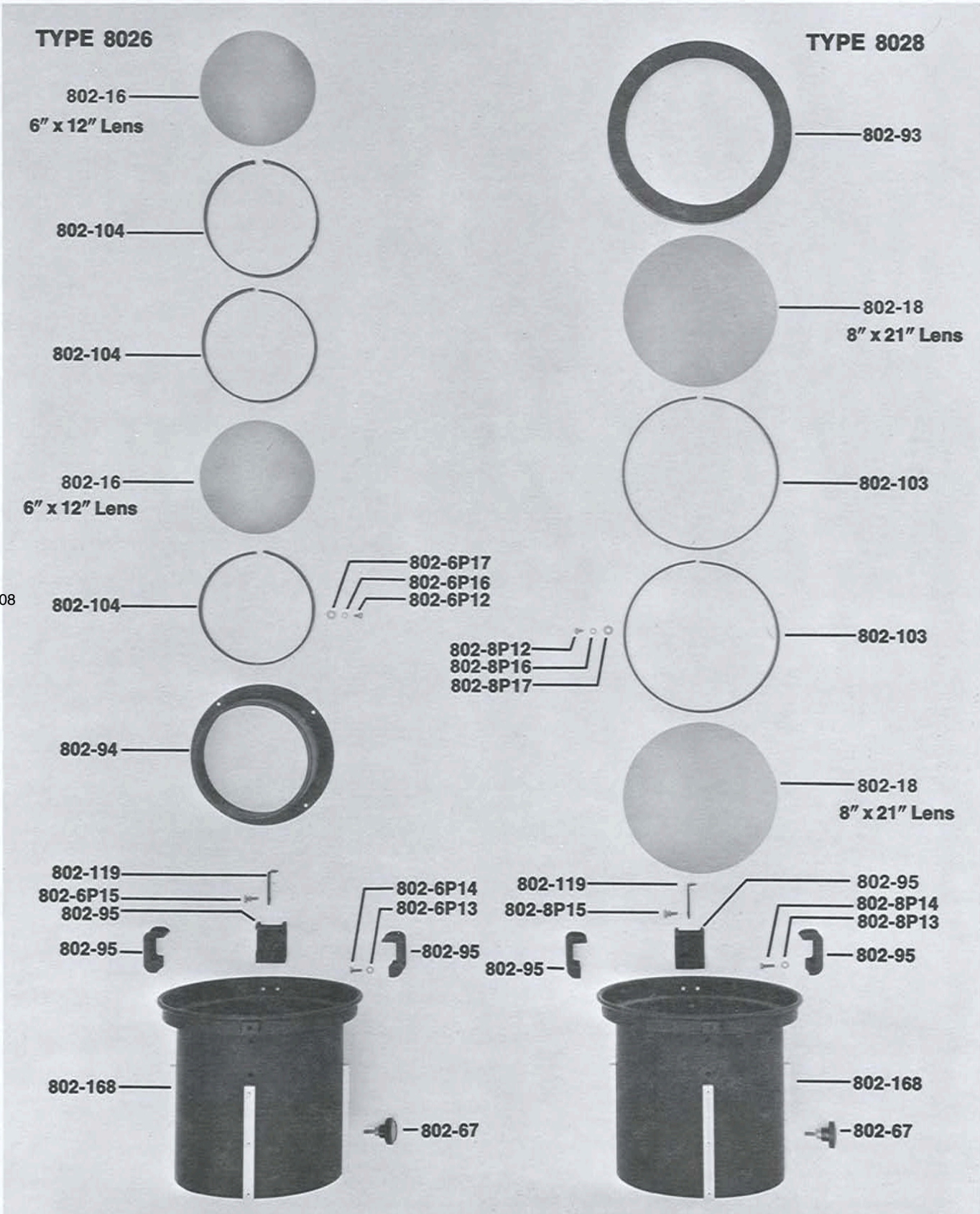

*Mole-Richardson Co.*



Tel. (323) 851-0111 Fax. (323) 851-5593 E-mail: info@mole.com Internet: http://www.mole.com 937 N. Sycamore Ave., Hollywood, California 90038-2384 U.S.A.

©Mole-Richardson Co., Hollywood, California U.S.A.





# PARTS FOR TYPE 8022 AND 80212 ACCESSORY IRIS ASSEMBLIES

8021E941

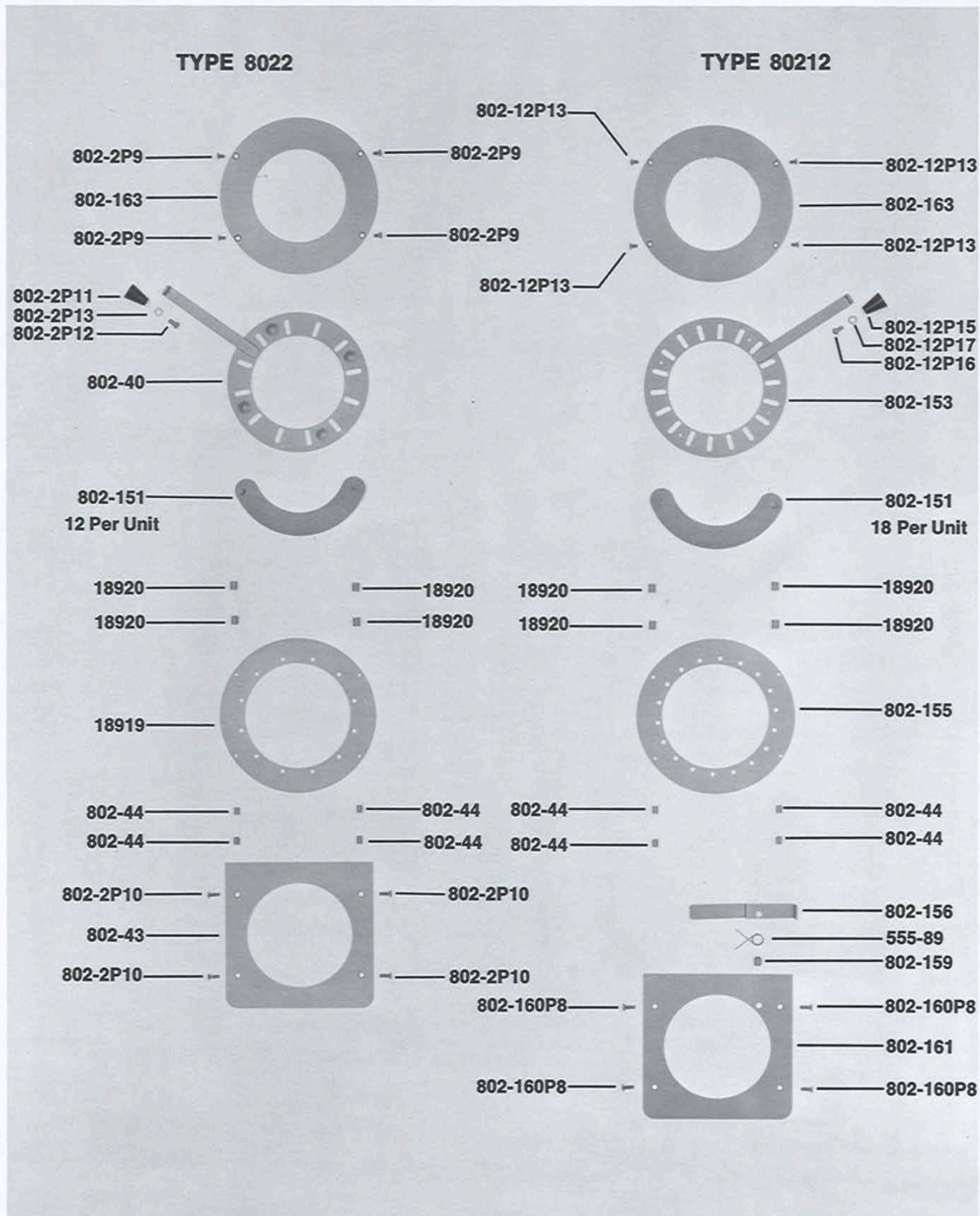

209



*Mole-Richardson Co.*

